

C. 64-218

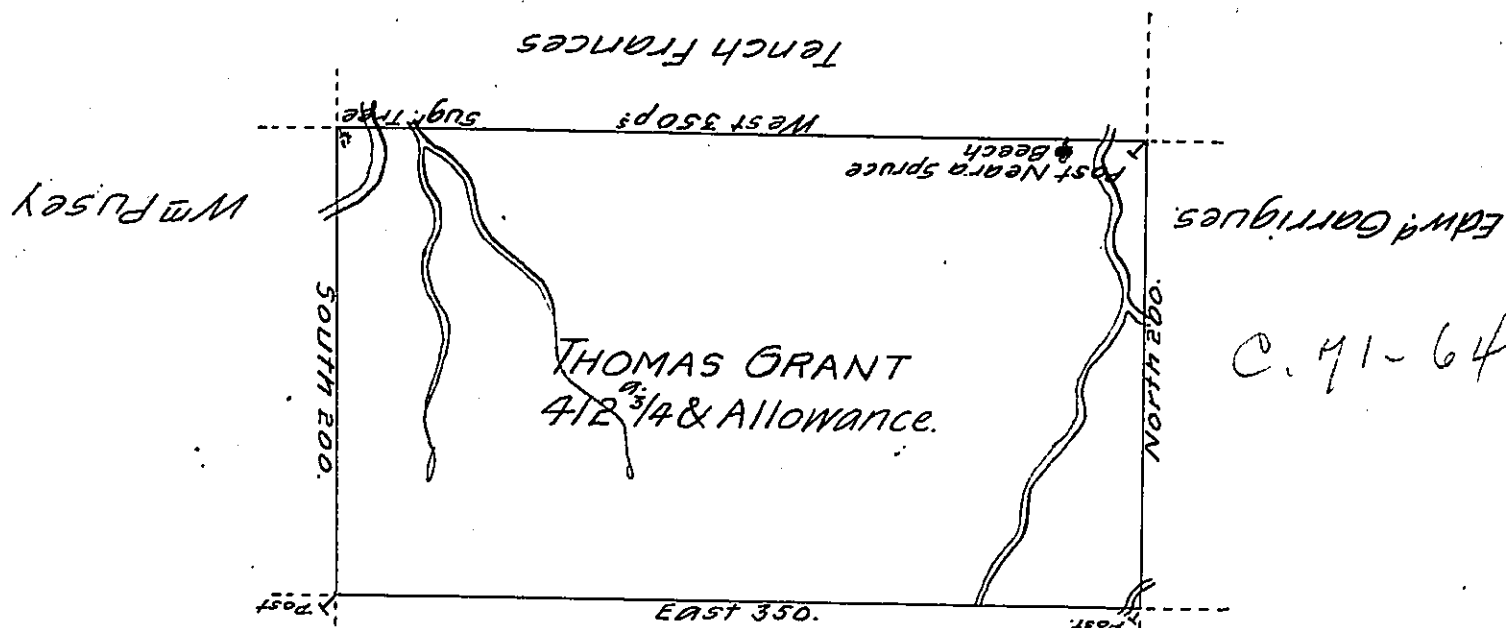

C. 41-64

Wm Gregory

THO'S GRANT
JACOB SH

Page 84

A Draught of a Tract of Land Called _____ Situate on the Waters of
 Snake Creek, Adjoining Land of William Gregory and others in Stoke
 Township \pm Northumberland County. Surveyd on the 28th day of Sep^r 17-
 87 for Thomas Grant, by Virtue of his Warrant bearing date the 27th day
 of July 1787. Containing four Hundred and Twelve Acres, and $\frac{3}{4}$ th and
 allowance of Six p Cent for Roads &c. by

W^m Gray D. S.

To John Lukens Esq^r
 Surveyor Genl

\pm now Luzerne County

IN TESTIMONY that the above is a copy of the original remaining on file in
 the Department of Internal Affairs of Pennsylvania, made
 conformably to an Act of Assembly approved the 16th day of
 February, 1833, I have hereunto set my Hand and caused
 the Seal of said Department to be affixed at Harrisburg,
 this eighth day of December 1904.

James D. Brown
 Secretary of Internal Affairs.